

Configuration

Dash #	Assy	Blank	Finish
-1	9019487-1	9019984-1	Black Anodized
-2	9019487-2	9019984-2	Black Anodized
-3	9019487-3	9019984-3	Gray Paint
-4	9019487-4	9019984-4	Gray Paint

Revision

ECO	Rev	Description	Date	Approved
	A	Production release.	07/24/23	MKN/MEK
7675	B	Added -3 and -4 configurations. Moved Note 4 (finish) information to configuration block.	09/18/23	MKN/VAA

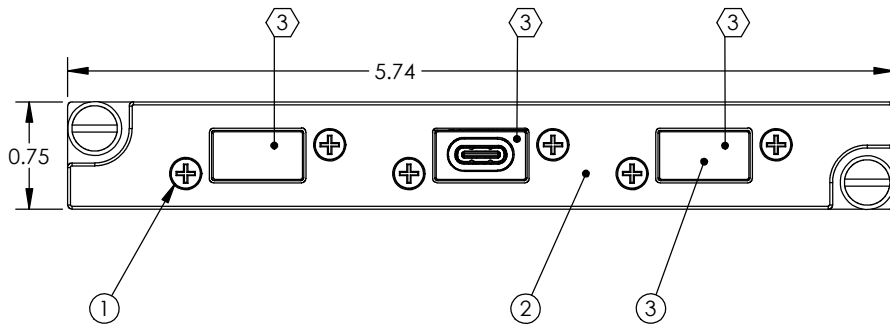
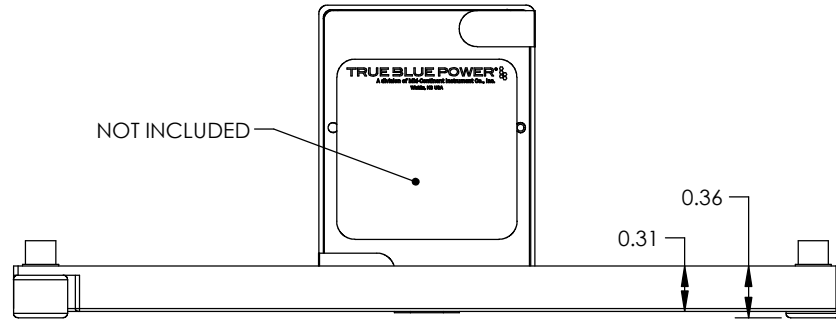

9010361-1/-3

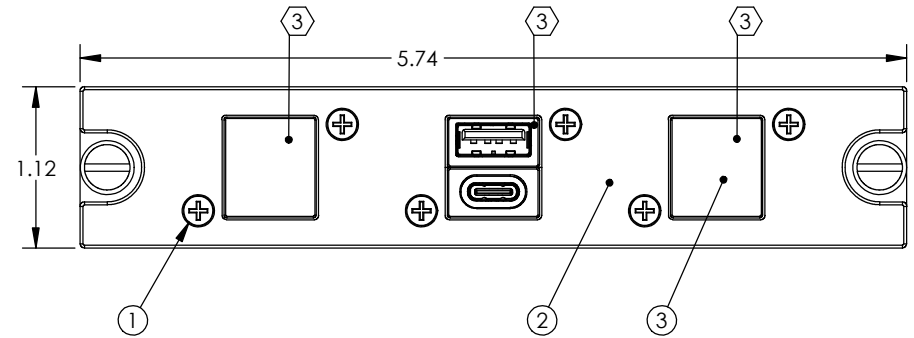
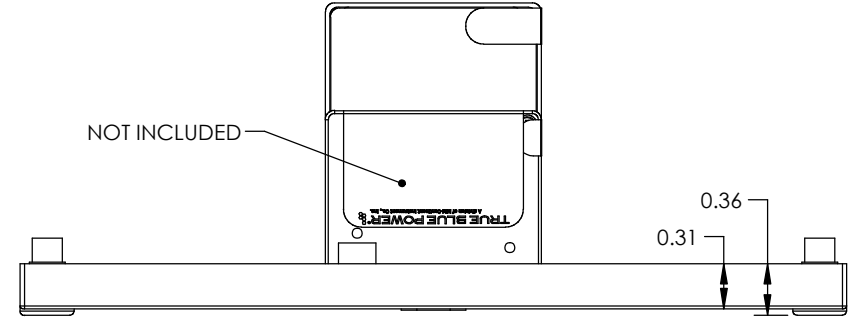

9010361-2/-4

Item	Qty	Part Number	Description
1	6	90-410-10011	Screw 4-40X5/16 Flat Phil Blk Patch
2	1	See config.	Assy, Adapter, USB, DZUS Mount, Single
3	2	See config.	Blank, USB Single

Item	Qty	Part Number	Description
1	6	90-410-10011	Screw 4-40X5/16 Flat Phil Blk Patch
2	1	See config.	Assy, Adapter, USB, DZUS Mount, Dual
3	2	See config.	Blank, USB Dual

Note:

- 9010361-1 is compatible with any True Blue Power single port TA202 or TA360 USB Charger.
- 9010361-2 is compatible with any True Blue Power dual port TA202 or TA360 USB Charger.
- The Adapter may be filled with up to three True Blue Power USB Chargers (Note 1 or 2). Empty openings may be filled with included USB Blanks (Item 3).

UNLESS OTHERWISE SPECIFIED, ALL DIMENSIONS ARE IN INCHES.
 TOLERANCE:
 .X= ±0.065
 .XX= ±0.015
 .XXX= ±0.005
 .XXXX= ±0.002
 ANGULAR= ±0.5°
 WEIGHT N.T.E. +5%
 BREAK ALL SHARP EDGES
 THREADS PER MIL-S-7742

DRAWN:

MKN
07/24/2023

APPROVED:

MEK
07/23/2023

This document discloses proprietary information of Mid-Continent Instrument Co., Inc. It may be reproduced or disclosed only with written permission of Mid-Continent Instrument Co. and is not to be used in any way detrimental to the interests of Mid-Continent Instrument Co., Inc.

TRUE BLUE POWER
 A division of Mid-Continent Instrument Co., Inc.

TITLE:
Adapter, USB, DZUS Mount

PART NUMBER:
9010361

SCALE: 3:4

DO NOT SCALE THIS DRAWING

SHEET: 1 of 1